

25.208. *

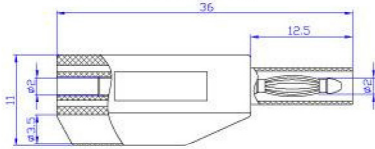

Material
 Insulator: PA
 Body: Brass
 Spring: Beryllium copper
 Surface: Nickel plated
 *Solder connection
Rated voltage/current
 CATII 600V/Max.10A



25.410. *



Material
 Insulator: PVC
 Body: Brass
 Spring: Steel
 Surface: Nickel plated
 *Screw connection
Rated voltage/current
 30Vac-60Vdc/Max.24A

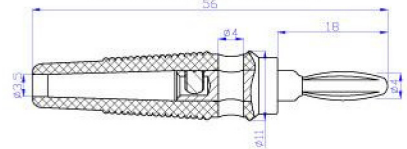

25.401. *



Material
 Insulator: ABS
 Body: Brass
 Spring: Beryllium copper
 Surface: Nickel plated
 *Screw connection
Rated voltage/current
 30Vac-60Vdc/Max.24A

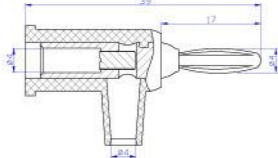

25.411. *



Material
 Insulator: PVC
 Body: Brass
 Spring: Steel
 Surface: Nickel plated
 *Screw connection
Rated voltage/current
 30Vac-60Vdc/Max.24A

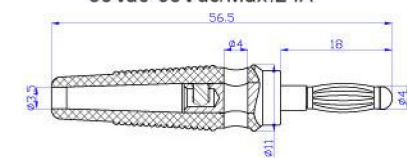

25.402. *



Material
 Insulator: ABS
 Body: Brass
 Spring: Phosphorus copper
 Surface: Nickel plated
 *Solder connection
Rated voltage/current
 30Vac-60Vdc/Max.19A

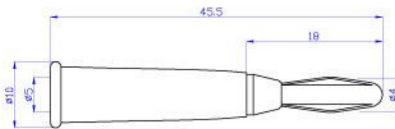

25.412. *



Material
 Insulator: PVC
 Body: Brass
 Spring: Beryllium copper
 Surface: Nickel plated
 *Screw connection
Rated voltage/current
 30Vac-60Vdc/Max.24A

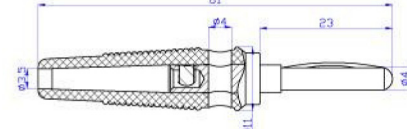

25.403. *



Material
 Insulator: PE
 Body: Brass
 Spring: Beryllium copper
 Surface: Nickel plated
 *Screw connection
Rated voltage/current
 30Vac-60Vdc/Max.32A

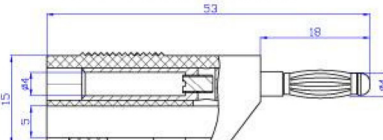

25.413. *



Material
 Insulator: PVC
 Body: Brass
 Spring: Phosphorus copper
 Surface: Nickel plated
 *Screw connection
Rated voltage/current
 30Vac-60Vdc/Max.32A

